

Cut Out Notes Plaster In Beading

QUAD 46 – cut out 54mm x L* + 8mm
QUAD 62 - cut out 70mm x L* + 8mm
QUAD 100 - cut out 108mm x L* + 8mm

Cut Out Notes Plaster In Brackets

QUAD 46 – cut out 49mm x L* + 3mm
QUAD 62 - cut out 66mm x L* + 4mm
QUAD 100 - cut out 104mm x L* + 4mm

Diffuser Removal

1

Opal Snap-in

Lift and tilt

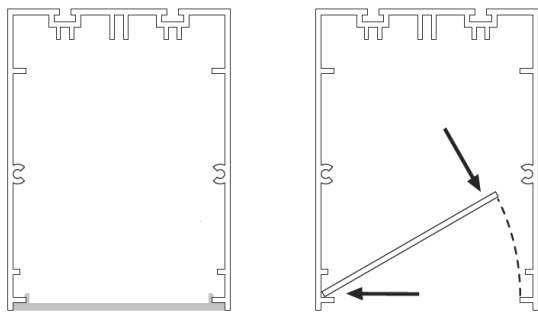

LED Tray Removal

2a

Remove the corresponding LED tray from over the bracket mounting to allow access.

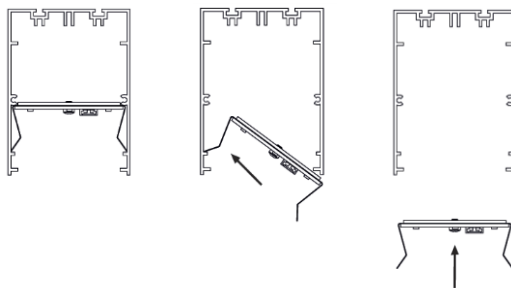

LED Tape Removal

2b

Unclip the FIRO profile from the white plastic mounting clips – *NB # don't hang the profile from the wires.*

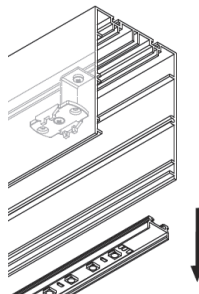

Mounting Plaster In Brackets

3a

Slot bracket into the ceiling void, and screw into place using 4 no. self tapping screws.

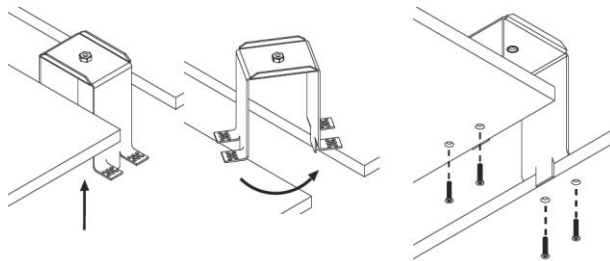

Mounting The Profile To Brackets

4a

Slide the fixing bolts through the profile, and the bracket wings, lift the profile into the ceiling void and screw into the ceiling bracket.

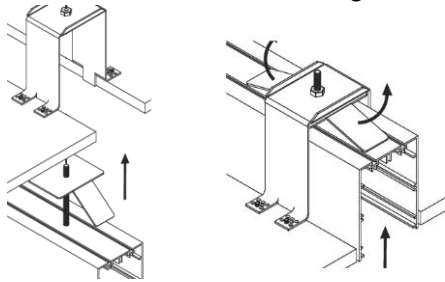

Mounting Plaster in Beading

3b

Slide the profile up into the ceiling void, screw through the metal into the plasterboard, and skim.

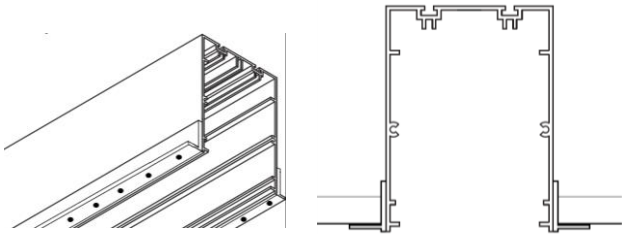

Wiring

5

Ensure all terminations are complete and secure.

Please use document

Optelma Wiring Instructions – REV V

Reassembly of Luminaire

6

Reassembly is the reverse of the previous stages 1 and 2.

Additional Fixings - End Cap

Two countersunk screws hold each endcap to the profile

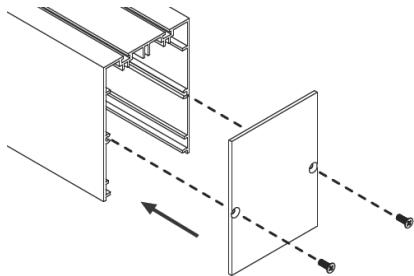

Additional Fixings – Flush Connector

Four screws in each profile to grip the flush connector, do not overtighten.

